

e-slide



STEEL QUALITY	EN 10025-2:2004 - S235JR, cold drawn NBN A 24-302 - BE 500 TS EN 10111:2008 - DD14
MATERIAL THICKNESS	2 x 5 mm (13/64") upper Slide® waves Body 1,5 mm (1/16")
PROFILE LENGTH	2,60 m (+ 5 mm / - 10 mm) (8.53 ft +13/64" / - 25/64")
JOINT OPPENING	Optimal and recommended up to 15 mm (19/32"), load transfer possible up to 25 mm (1")
ANCHORAGE	Patented, specially 3D formed rebar \varnothing 6 mm (15/64") as continuous anchorage
VERSIONS	Natural steel / Galvanized / Stainless steel AISI 304 or AISI 316
PALLET SIZE	Length 2,60 m (8.53 ft), Width 1,15 m (3.77 ft), height see table

Height a [mm] (inch)	Slab thickness [mm] (inch)	b [mm] (inch)	Weight [kg/m] (lbs/ft)	Weight [kg/pc.] (lbs/pc.)	Quantity [pcs./pal.]	Quantity [m/pal.] (ft/pal.)	Gross weight per pal. [kg] (lbs)	Pallet Height [m] (ft)
130 (5 1/8)	140 - 150 (5 33/64 - 5 29/32)	30 (1 3/16)	8,20 (5.58)	21,32 (47.00)	56	145,6 (477.69)	1285 (2844)	1,15 (3.77)
155 (6 7/64)	160 - 180 (6 19/64 - 7 3/32)	65 (2 9/16)	8,61 (5.79)	22,39 (49.36)	49	127,4 (417.98)	1150 (2535)	1,26 (4.13)
180 (7 3/32)	190 - 200 (7 31/64 - 7 7/8)	90 (3 35/64)	8,91 (5.99)	23,16 (51.06)	42	109,2 (358.27)	1025 (2260)	1,20 (3.94)
205 (8 1/16)	210 - 230 (8 1/4 - 9 1/16)	115 (4 17/32)	9,25 (6.22)	24,06 (53.04)	35	91,0 (298.56)	920 (2030)	1,10 (3.61)

The e-slide joint is recommended for the use in light and medium loaded floors and for floor thickness' between 140 and 200 mm (5.5" - 8"). Other heights for floor thicknesses above 200 mm (8") are available on request and function of the corresponding design check.

ATTENTION: The load transfer capacity of e-slide® is reduced when compared to Cosinus Slide® but is still considerably greater than discontinued plate- or doweled joints. For calculations, validations and optimal use of the joints for your respective projects, please contact your local dealer or send a request to info@hcjoints.be.

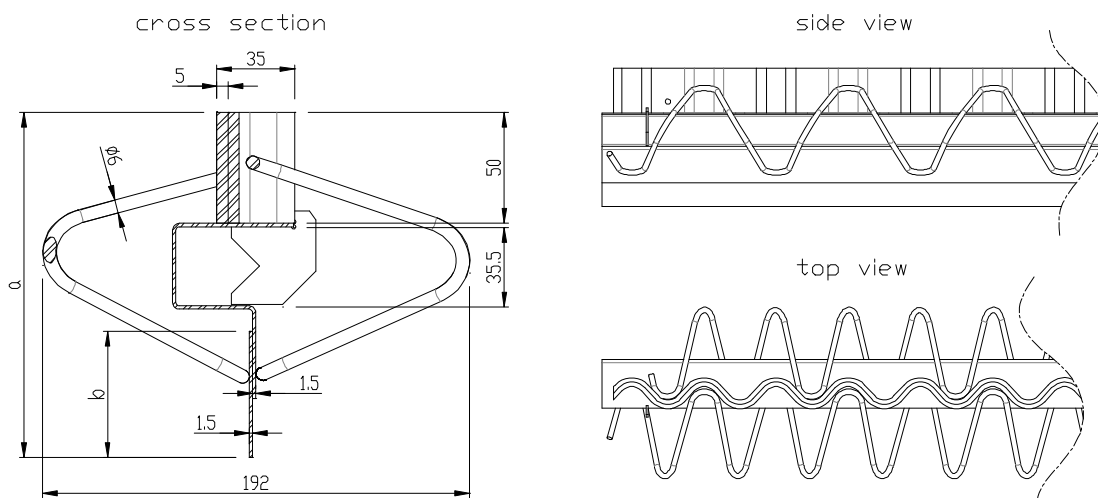

Document issued August 2021. Hengelhoef Concrete Joints nv. reserves the right to alter the products without notice.
©COPYRIGHT 2021 by Hengelhoef Concrete Joints nv.



HENGELHOEF
CONCRETE JOINTS

Hengelhoefstraat 158, Poort Genk 0420, B-3600 Genk
T. +32 (0)89 32 39 80 · F. +32 (0)89 32 39 88
E. info@hcjoints.be

www.hcjoints.be

The follow table shows the load transfer capacity in [kN/m] of the **e-slide** construction joint at ULS for plain concrete and a joint opening of 15 mm. The values are based on the following formula which is derived from laboratory testing results in accordance with EN 1990 (EC0).

$$V_{Rd,c} = 0,0525 / \gamma_c \cdot k^{3/2} \cdot f_{ck}^{1/2} \cdot 0,60 \cdot h / 1,4 \text{ [kN/m]}$$

with: $\gamma_c = 1,50$ [-]; $k = 1 + (200 / d)^{0,5} \leq 2,0$; $d = h - 60\text{mm}$



e-slide load transfer capacity in [kN/m] (kips/ft)			
Slab height h [mm] (inch)	unreinforced (plain) concrete		
	C25/30 (3600 PSI)	C30/37 (4350 PSI)	C35/45 (5000 PSI)
140 (5 1/2)	29,70 (2.03)	32,53 (2.23)	35,14 (2.41)
150 (6)	31,82 (2.18)	34,86 (2.39)	37,65 (2.58)
160 (6 3/8)	33,94 (2.33)	37,18 (2.55)	40,16 (2.75)
170 (6 3/4)	36,06 (2.47)	39,50 (2.71)	42,67 (2.92)
180 (7)	38,18 (2.62)	41,83 (2.87)	45,18 (3.10)
190 (7 1/2)	40,31 (2.76)	44,15 (3.03)	47,69 (3.27)
200 (8)	42,43 (2.91)	46,48 (3.18)	50,20 (3.44)
210 (8 1/4)	44,55 (3.05)	48,80 (3.34)	52,71 (3.61)
220 (8 3/4)	46,67 (3.20)	51,12 (3.50)	55,22 (3.78)

The table only provides the material capacity at ULS (safety: $\gamma = 1,5$). This table does not replace the necessary design check. The design check is available for each project upon request.

The e-slide construction joint is recommended for use in light and medium loaded floors and for floor thickness' between 140 and 220 mm (5.5" – 8 3/4"). Higher joints for floor thicknesses above 220 mm (8 3/4") are available on request and function of the corresponding design check. For further information with regards to the installation, please consult the e-slide installation guide.

ATTENTION: The load transfer capacity of e-slide is reduced when compared to Cosinus Slide® but is still considerably greater than discontinued plate- or doweled joints. For calculations, validations and optimal use of the joints for your respective projects, please contact your local dealer or send a request to info@hcjoints.be.

Document issued January 2022. Hengelhoef Concrete Joints nv. reserves the right to alter the products without notice.

©COPYRIGHT 2022 by Hengelhoef Concrete Joints nv.



HENGELHOEF
CONCRETE JOINTS

Hengelhoefstraat 158, Poort Genk 0420, B-3600 Genk
T. +32 (0)89 32 39 80 · F. +32 (0)89 32 39 88
E. info@hcjoints.be

www.hcjoints.be